



**BARNETT**  
**Commercial Realty, Inc.**

5 East Church Street  
Martinsville, VA 24112  
Tel: 276.656.3538  
Fax: 276.656.3639

## **Spruce Street Station (Principals Only)**

1101 Brookdale Street  
Martinsville, VA 24112

For more information contact [Jim Barnett, CCIM](#)

**Sale Price: \$5,400,000**



Strip Mall with 7 Spaces,  
totaling 48,052 SF located  
on 8.682 AC Parking Lot.

8.84% CAP Rate / 2011  
NOI \$477,251 / 87%  
Occupancy

Tenants include Food  
Lion, Curves, A Cut Above  
and ShunXing Restaurant.

**Property Type:** retail  
**Property Status:** available



# BARNETT Commercial Realty, Inc.

5 East Church Street  
Martinsville, VA 24112  
Tel: 276.656.3538  
Fax: 276.656.3639

## Spruce Street Station (Principals Only)

1101 Brookdale Street  
Martinsville, VA 24112

Sale Price: **\$5,400,000**

For more information contact [Jim Barnett, CCIM](#)

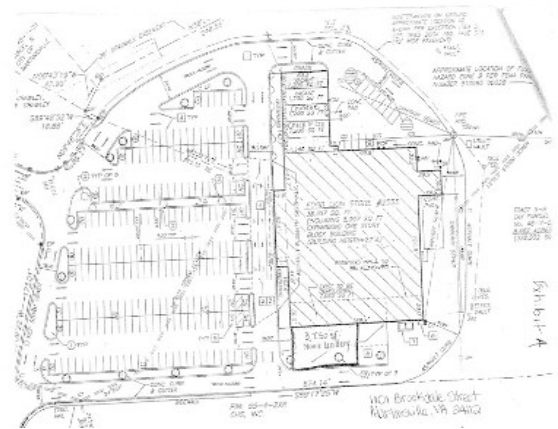
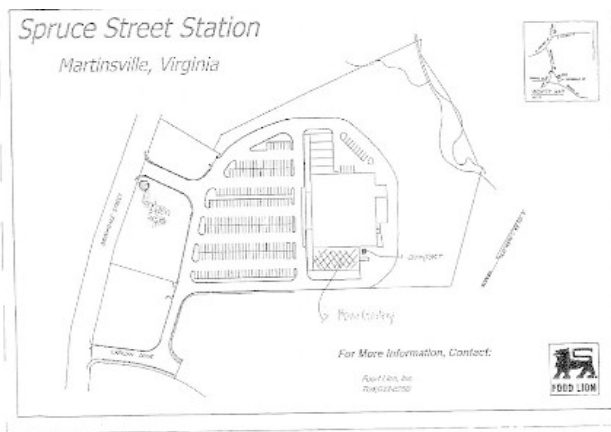



**BARNETT**  
**Commercial Realty, Inc.**

---

5 East Church Street  
Martinsville, VA 24112  
Tel: 276.656.3538  
Fax: 276.656.3639

## Spruce Street Station (Principals Only)

1101 Brookdale Street  
Martinsville, VA 24112

Sale Price: **\$5,400,000**

For more information contact [Jim Barnett, CCIM](#)





**B A R N E T T**  
**Commercial Realty, Inc.**

---

5 East Church Street  
Martinsville, VA 24112  
Tel: 276.656.3538  
Fax: 276.656.3639

## **Spruce Street Station (Principals Only)**

1101 Brookdale Street  
Martinsville, VA 24112

For more information contact [Jim Barnett, CCIM](#)

**Sale Price: \$5,400,000**